

Sale
Industrial
Exclusive Listing

Property Information
680 Elton Street, Riverhead, NY 11901

Gross Building Area:	66,307	Sprinklered:	Yes	Fuel:	Gas
Sale Price:	\$4,495,000	Sewers:	Yes	Power:	400 amps
Price PSF:	\$67.79	Possession:	Immediate	Loading Docks	7
RE Taxes PSF:	\$2.28	Lot Size (Acres):	11.09	Ceiling Hgt:	20
		Zoning:	CRC		
		Year Built:	1945		
		Stories:	1		

680 Elton Street is an industrial/R&D facility consisting of two buildings totaling approximately 66,307sf. The first building was built in 1945 and measures 36,000sf including a 3,000sf office space built in the 1980's and recently renovated. The building is constructed of concrete block with a pitched roof and features 4 loading docks. The second building is a steel Butler building totaling 30,000sf (built in 2002) and featuring 20' clear height ceilings, 50' column spacing, 3 loading docks, a 50kw solar system and a Johnson Air Rotation System. Both buildings are fully sprinklered. The buildings are sited on a 11.09 acre parcel with expansion potential and frontage on Elton St. and East Main St. in Riverhead, NY. The intersection is signaled and well located 1/2 mile southwest of Old Country Road (County Road 58) and one mile northeast of downtown Riverhead. The current zoning is Commercial/Residential Campus and the property can be used as-is or expanded/redeveloped into a number of uses including residential, office, retail/restaurant, recreational and/or mixed use.

For Information, please contact: Neil Crawford

(631) 761-9407 Direct Dial

 Email ncrawford@cbcli.com
CBCLI.COM

This statement with the information it contains is given with the understanding that negotiations relating to the purchase, renting or leasing of this property shall be conducted through this office. The information while not guaranteed has been secured from sources we believe to be reliable however, it is up to the buyer or tenant to verify the information and conduct appropriate due diligence. Coldwell Banker Commercial and its Logo are registered service marks owned by Coldwell Banker Real Estate, LLC. Each Office is Independently Owned and Operated. All Rights Reserved. © 2017-18

 Coldwell Banker Commercial Island Corporate Services
 1601 Veterans Memorial Highway, Suite 420
 Islandia, NY 11749

Sale

Industrial

Exclusive Listing



Butler building



Original building

For Information, please contact: Neil Crawford

(631) 761-9407 Direct Dial

Email ncrawford@cbcli.com

CBCLI.COM

This statement with the information it contains is given with the understanding that negotiations relating to the purchase, renting or leasing of this property shall be conducted through this office. The information while not guaranteed has been secured from sources we believe to be reliable however, it is up to the buyer or tenant to verify the information and conduct appropriate due diligence. Coldwell Banker Commercial and its Logo are registered service marks owned by Coldwell Banker Real Estate, LLC. Each Office is Independently Owned and Operated. All Rights Reserved. © 2017-18

Coldwell Banker Commercial Island Corporate Services
1601 Veterans Memorial Highway, Suite 420
Islandia, NY 11749

Sale

Industrial

Exclusive Listing



Interior Butler building



Loading docks

For Information, please contact: Neil Crawford

(631) 761-9407 Direct Dial

Email ncrawford@cbcli.com

CBCLI.COM

This statement with the information it contains is given with the understanding that negotiations relating to the purchase, renting or leasing of this property shall be conducted through this office. The information while not guaranteed has been secured from sources we believe to be reliable however, it is up to the buyer or tenant to verify the information and conduct appropriate due diligence. Coldwell Banker Commercial and its Logo are registered service marks owned by Coldwell Banker Real Estate, LLC. Each Office is Independently Owned and Operated. All Rights Reserved. © 2017-18

Coldwell Banker Commercial Island Corporate Services
1601 Veterans Memorial Highway, Suite 420
Islandia, NY 11749

Sale

Industrial

Exclusive Listing



For Information, please contact: Neil Crawford

(631) 761-9407 Direct Dial

Email ncrawford@cbcli.com

CBCLI.COM

This statement with the information it contains is given with the understanding that negotiations relating to the purchase, renting or leasing of this property shall be conducted through this office. The information while not guaranteed has been secured from sources we believe to be reliable however, it is up to the buyer or tenant to verify the information and conduct appropriate due diligence. Coldwell Banker Commercial and its Logo are registered service marks owned by Coldwell Banker Real Estate, LLC. Each Office is Independently Owned and Operated. All Rights Reserved. © 2017-18

Coldwell Banker Commercial Island Corporate Services
1601 Veterans Memorial Highway, Suite 420
Islandia, NY 11749

Sale

Industrial

Exclusive Listing

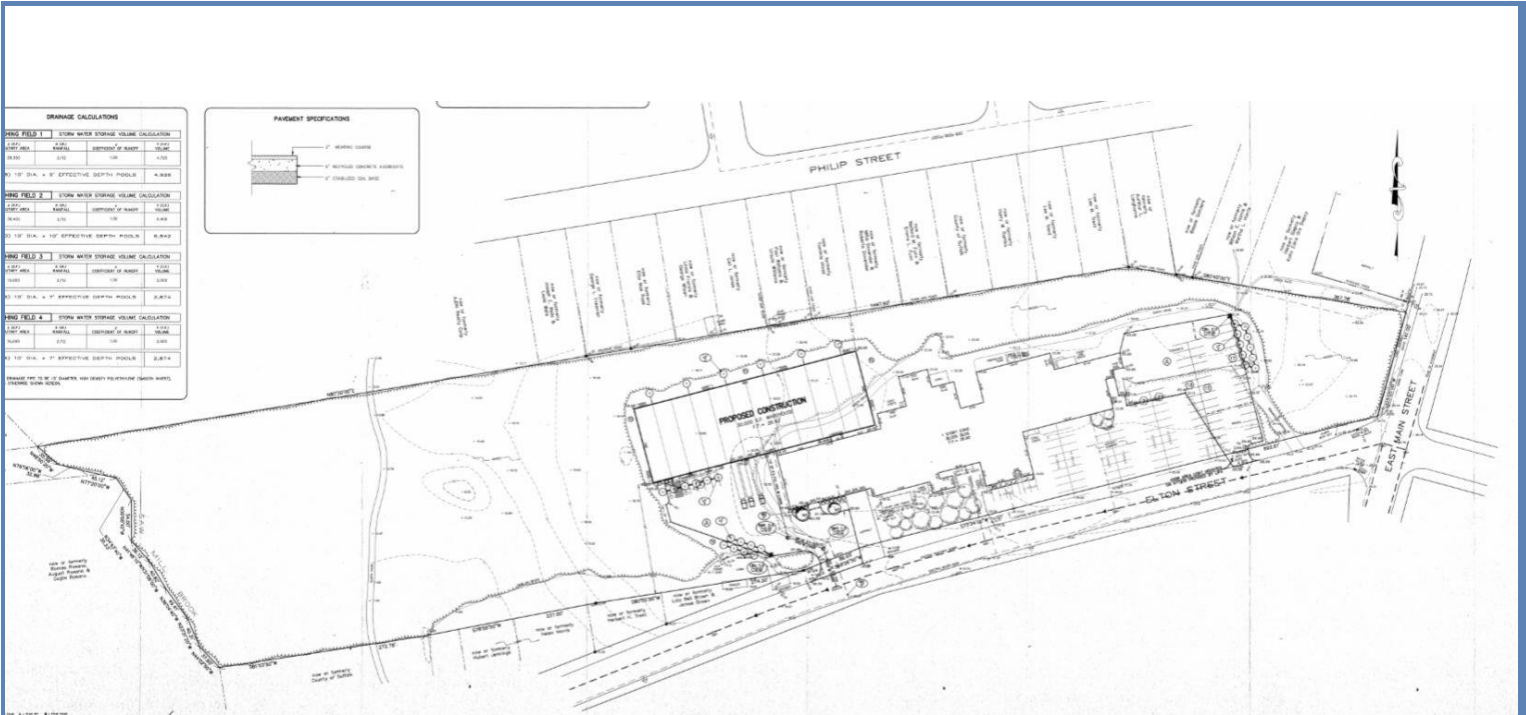

Survey

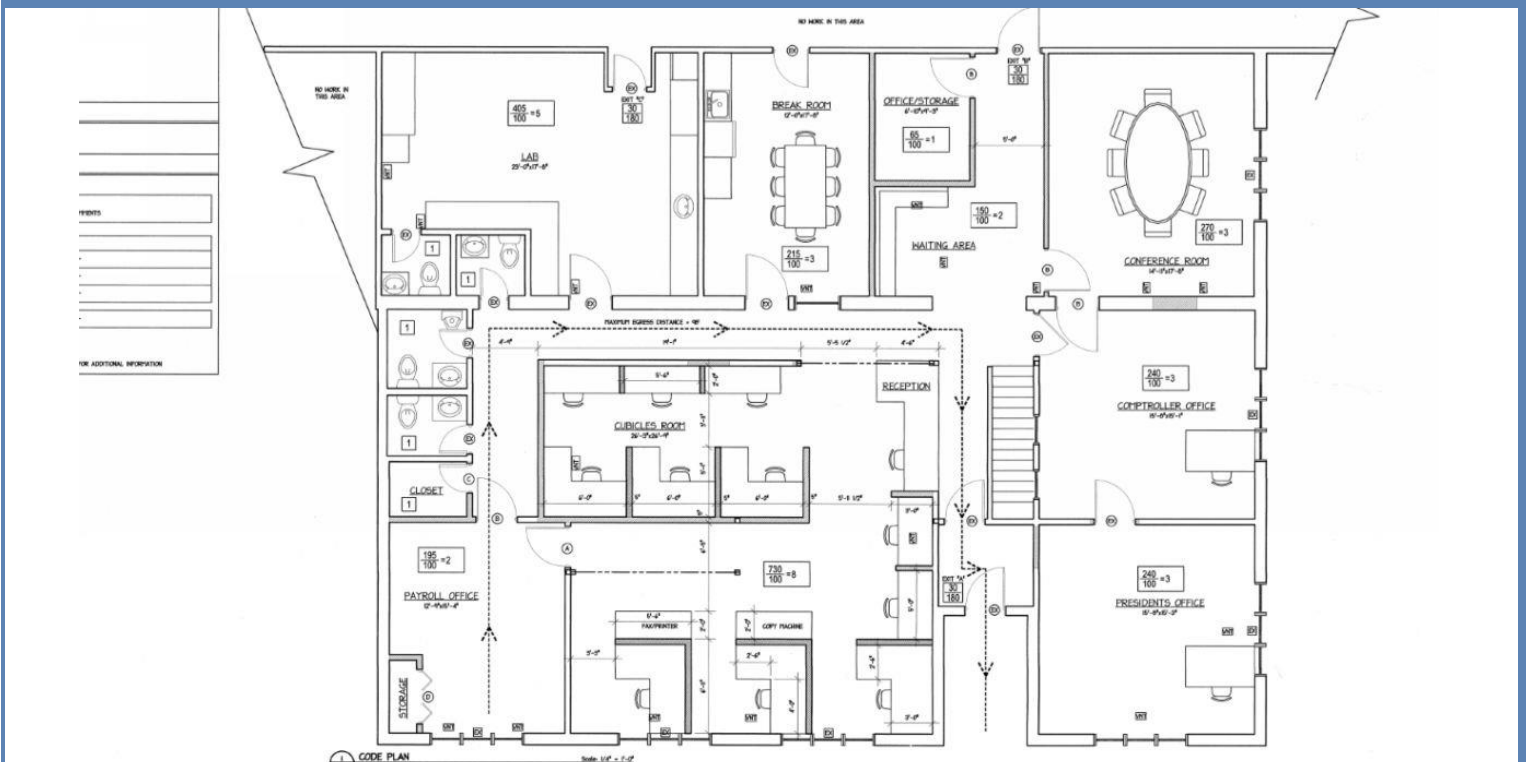

Office space plan

For Information, please contact: Neil Crawford

(631) 761-9407 Direct Dial

Email ncrawford@cbcli.com

CBCLI.COM

This statement with the information it contains is given with the understanding that negotiations relating to the purchase, renting or leasing of this property shall be conducted through this office. The information while not guaranteed has been secured from sources we believe to be reliable however, it is up to the buyer or tenant to verify the information and conduct appropriate due diligence. Coldwell Banker Commercial and its Logo are registered service marks owned by Coldwell Banker Real Estate, LLC. Each Office is Independently Owned and Operated. All Rights Reserved. © 2017-18

Coldwell Banker Commercial Island Corporate Services
1601 Veterans Memorial Highway, Suite 420
Islandia, NY 11749

Sale

Industrial

Exclusive Listing

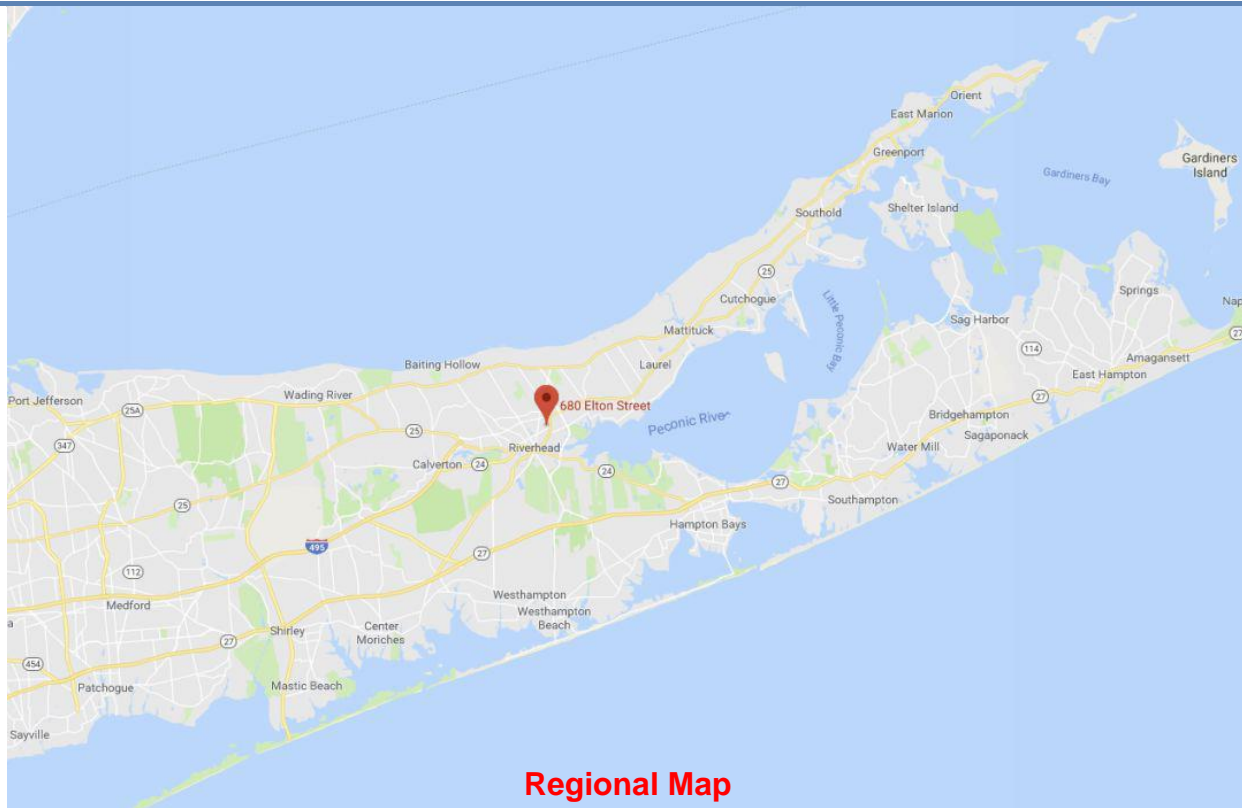

Regional Map

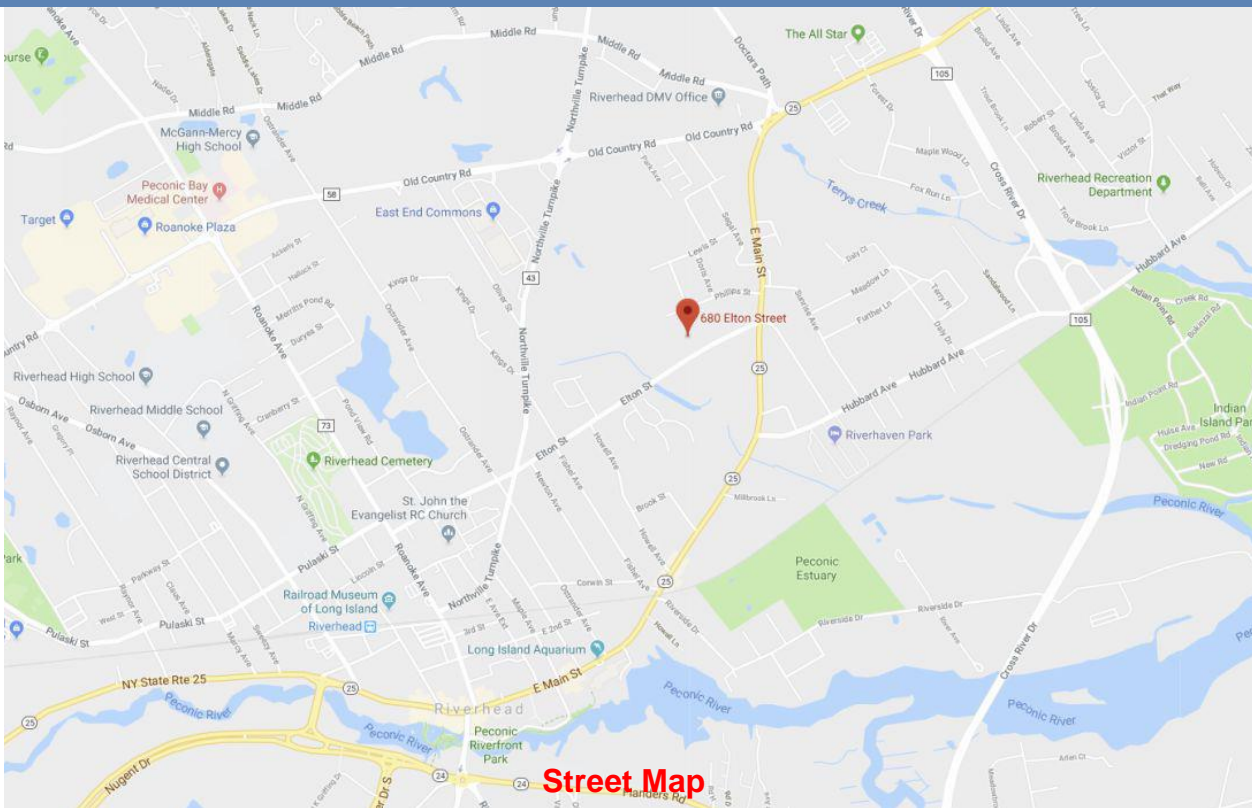

Street Map

For Information, please contact: Neil Crawford

(631) 761-9407 Direct Dial

Email ncrawford@cbcli.com

CBCLI.COM

This statement with the information it contains is given with the understanding that negotiations relating to the purchase, renting or leasing of this property shall be conducted through this office. The information while not guaranteed has been secured from sources we believe to be reliable however, it is up to the buyer or tenant to verify the information and conduct appropriate due diligence. Coldwell Banker Commercial and its Logo are registered service marks owned by Coldwell Banker Real Estate, LLC. Each Office is Independently Owned and Operated. All Rights Reserved. © 2017-18

Coldwell Banker Commercial Island Corporate Services
1601 Veterans Memorial Highway, Suite 420
Islandia, NY 11749